

DC12-65 12V65AH

DC SERIES-Deep Cycle Battery

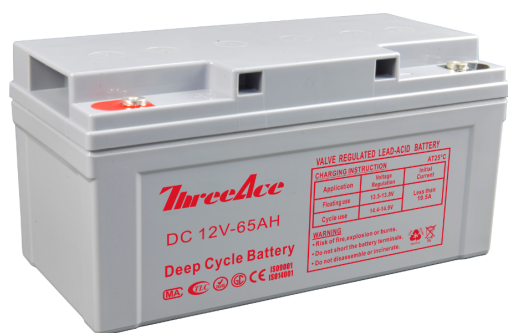

Specification

Nominal Voltage	12V	
Nominal Capacity(10HR)	65AH	
Dimension	Length	348 ± 3mm (13.70 inches)
	Width	167 ± 2mm (6.57 inches)
	Container Height	178 ± 2mm (7.01 inches)
	Total Height (with Terminal)	178 ± 2mm (7.01 inches)
Approx Weight	Approx 19.05 Kg (42.1lbs)	
Terminal	T6 / T10	
Container Material	ABS	
Rated Capacity	67.9 AH/3.39A	(20hr , 1.80V/cell, 25°C/77°F)
	65.0 AH/6.50A	(10hr, 1.80V/cell, 25°C/77°F)
	56.2 AH/11.2A	(5hr, 1.75V/cell, 25°C/77°F)
	51.0 AH/17.0A	(3hr, 1.75V/cell, 25°C/77°F)
	39.9 AH/39.9A	(1hr, 1.60V/cell, 25°C/77°F)
Max. Discharge Current	780A (5s)	
Internal Resistance	Approx 7.4 mΩ	
Operating Temp. Range	Discharge	-15 ~ 50°C (5 ~ 122°F)
	Charge	0 ~ 40°C (32 ~ 104°F)
	Storage	-15 ~ 40°C (5 ~ 104°F)
Nominal Operating Temp. Range	25 ± 3°C (77 ± 5°F)	
Cycle Use	Initial Charging Current less than 19.5A. Voltage 14.4V~14.9V at 25°C(77°F)Temp. Coefficient -30mV/°C	
	Standby Use	
Capacity affected by Temperature	40°C (104 °F)	103%
	25°C (77 °F)	100%
	0°C (32 °F)	86%
Self Discharge	ThreeAce DC series batteries may be stored for up to 6 months at 25°C(77°F) and battery should be recharged before use. For higher temperatures the time interval will be shorter.	

Applications

- ◆ Electric tools
- ◆ Vehicle in place of walking
- ◆ Lawn mowers
- ◆ Golf trolleys and golf cart
- ◆ Portable apparatus, lights and instruments;
- ◆ Electric toys
- ◆ Illumination light
- ◆ Fire alarms
- ◆ Portable power
- ◆ Wheelchairs
- ◆ Medical equipments.

ISO 9001	ISO 14001	OHSAS 18001	TLC
CE	RoHS	UL	Battery

Constant Current Discharge (Amperes) at 25 °C (77°F)

F.V/Time	5min	10min	15min	30min	45min	1h	2h	3h	5h	8h	10h	20h
1.80V	151.2	96.4	81.9	52.3	38.4	35.3	22.4	15.8	10.7	7.1	6.3	3.50
1.75V	157.2	100.2	85.2	54.4	40.0	36.7	23.3	16.4	11.1	7.3	6.6	3.64
1.70V	160.3	102.2	86.8	55.4	40.7	37.4	23.8	16.7	11.4	7.5	6.7	3.71
1.65V	163.3	104.1	88.5	56.5	41.5	38.1	24.2	17.0	11.6	7.6	6.8	3.78
1.60V	166.3	106.0	90.1	57.5	42.3	38.8	24.7	17.3	11.8	7.8	6.9	3.85

Constant Power Discharge (Watts) at 25 °C (77°F)

F.V/Time	5min	10min	15min	30min	45min	1h	2h	3h	5h	8h	10h	20h
1.80V	291.1	185.6	157.7	100.7	74.0	67.9	43.2	30.3	20.6	13.6	12.1	6.7
1.75V	302.7	193.0	164.0	104.7	76.9	70.6	44.9	31.5	21.4	14.1	12.6	7.0
1.70V	308.5	196.7	167.1	106.7	78.4	72.0	45.8	32.1	21.9	14.4	12.9	7.1
1.65V	314.3	200.4	170.3	108.7	79.9	73.3	46.6	32.7	22.3	14.7	13.1	7.3
1.60V	320.2	204.1	173.4	110.7	81.4	74.7	47.5	33.4	22.7	14.9	13.3	7.4

Note The above data are average values, and can be obtained with 3 charge/discharge cycles. These are not minimum values.

DC12-65 12V65AH

DC SERIES-Deep Cycle Battery

Dimensions

T6 Terminal

Unit: mm [inches]

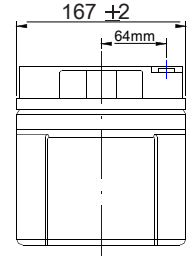
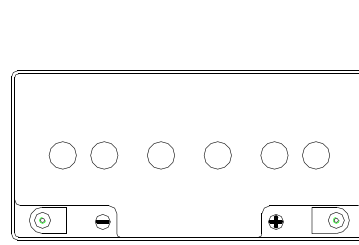
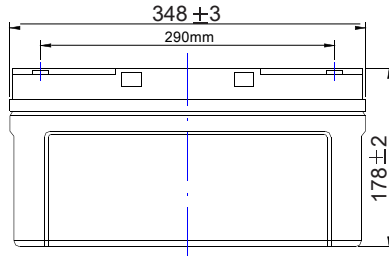
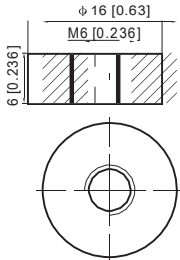

Charging Characteristics (cycle use)

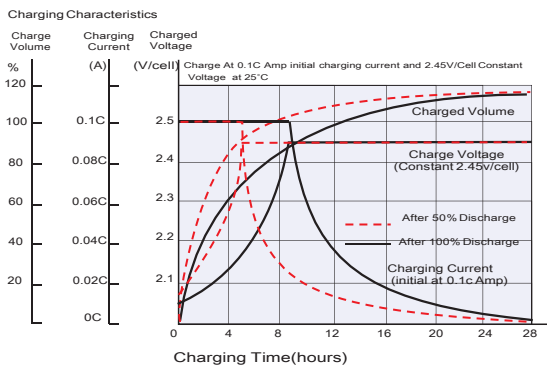

Discharge Characteristics

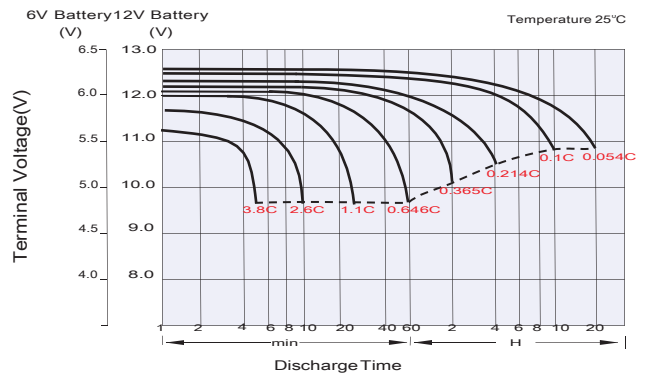

Temperature Effects in Relation to Battery Capacity

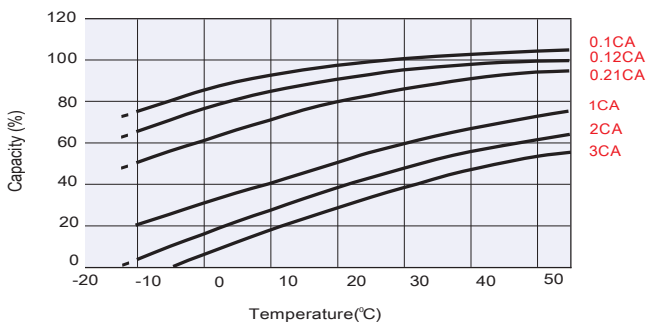

Cycle Life in Relation to Depth of Discharge

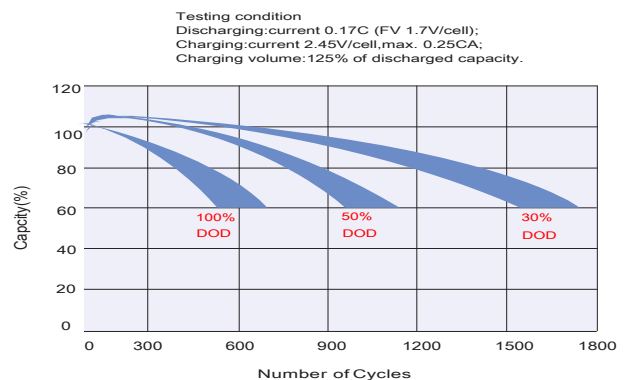

Self Discharge Characteristics

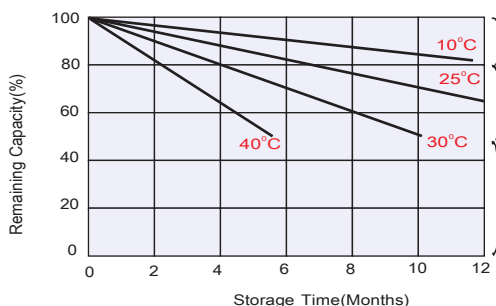

No supplementary charge required

(Carry out supplementary charge before use if 100% capacity is required.)

Supplementary charge required before use. Optional charging way as below:

1. Charged for above 3 days at limited current 0.25CA and constant voltage 2.25V/cell.
2. Charged for above 20 hours at limited current 0.25CA and constant voltage 2.45V/cell.
3. Charged for 8~10 hours at limited current 0.05CA.

Supplementary charge may often fail to recover the capacity.

The battery should never be left standing till this is reached.

THREEACE DC BATTERIES

This information is generally descriptive only and is not intended to make or imply any representation, guarantee or warranty with respect to any cells and batteries. Cell and battery designs/ specification are subject to modification without notice. Contact us for the latest information.